



MTL LODGE FIRE SAFETY



By Tom Knudsen



**WE FEEL THAT THE LODGE IS THE SAFEST
BUILDING OF ITS KIND IN VERMONT.**















- × FULL FIRE SPRINKLER SYSTEM WITH DESIGNATED WATER SUPPLY AND SMOKE DETECTORS THROUGHOUT

- × 3 FIRE DOORS CLOSE AUTOMATICALLY WHEN ALARM ACTIVATED OR POWER FAILURE



- × **REINFORCED BEDROOM DOORS**
- × **EXTRA SHEETROCKING**
- × **OUR HEATING SYSTEM IS AN ALL NEW PROPANE BOILER AND ELECTRICAL SYSTEMS—ALL ARE IN TOP CONDITION**



- × CENTRAL ALARM MONITORING ANNUNCIATOR PANEL NEXT TO FRONT DOOR IN PARLOR
- × ALARM PULL STATIONS AT ALL MAIN LEVEL ENTRY DOORS





× DRY POWDER
EXTINGUISHERS
THROUGHOUT

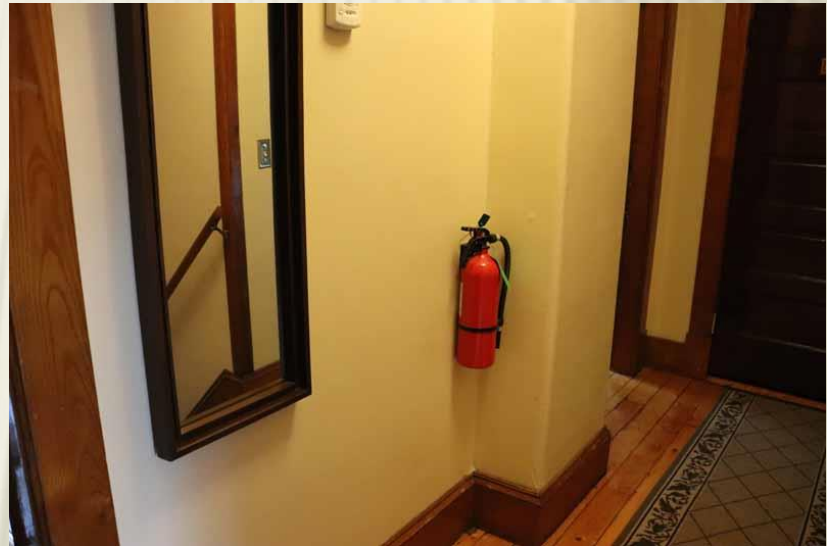



- × MANY EXIT OPTIONS FROM FIRST FLOOR AND SEVERAL FROM UPPER FLOORS.

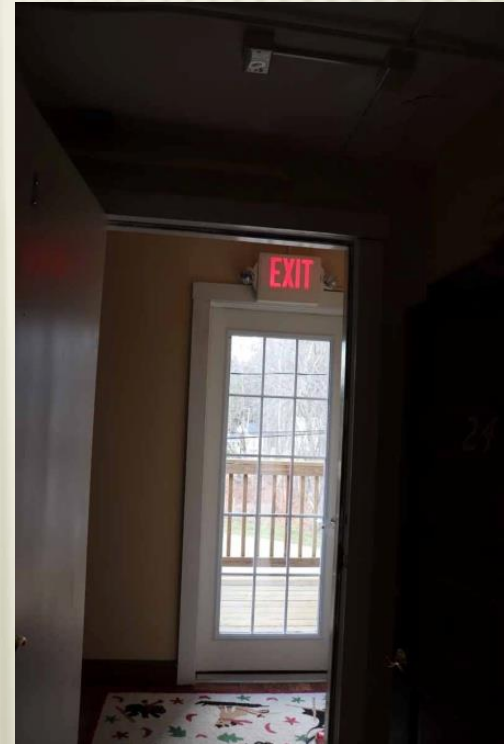



- × STAIRWAY FROM SECOND FLOOR PROTECTED BY FIRE DOOR
- × NEW THIRD FLOOR DORM AREA HAS STAIRWAY TO HALLWAY OF RENTAL APARTMENTS





PROPANE FIREPLACE



**USE CAUTION AROUND THE
PROPANE FIREPLACE**



THE KITCHEN

- × THE KITCHEN COULD BE A LIKELY FIRE SOURCE
- × NEVER PUT WATER ON A GREASE FIRE. INSTEAD, DROP A LID ON THE PAN OR USE EXTINGUISHER OR BAKING SODA.
- × USE CAUTION WITH LOOSE CLOTHING AROUND THE STOVES
- × DO NOT BLOCK THE FIRE DOOR WITH PERSONAL BAGS





SAFE PRACTICES

DON'T ASSUME ALARM IS FALSE!

- × KNOW YOUR ROOMMATES. ALERT OTHERS AND GET OUT.
- × MEET AT NORTH PARKING LOT.
- × BE PREPARED WITH COAT, SHOES AND KEYS READILY AVAILABLE
- × IN HEAVY SMOKE, STAY LOW WITH NOSE TO THE FLOOR
- × NO SMOKING OR CANDLES
- × “CONTROLLED” GROUP CAMPFIRE ALLOWED



ENJOY THE PARTY ROOM SAFELY!